

## MKT 22

## METALLISED POLYESTER FILM CAPACITORS AXIAL WRAP AND END FILL FORMAT

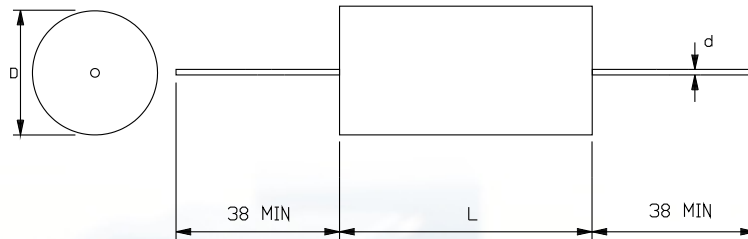

SEE TABLE OVERLEAF FOR CAPACITANCE VALUES AND MAX DIMENSIONS IN MM.

### GENERAL DETAILS

A RANGE OF AXIALLY LEADED CAPACITORS FOR GENERAL PURPOSE USE, WOUND IN ULTRA-THIN FILM AND SUPPLIED IN WRAP AND END FILL HOUSING TO GIVE OPTIMUM VOLUMETRIC EFFICIENCY. TYPICALLY 30% VOLUME SAVING OVER CONVENTIONAL COMPONENTS.

### TECHNICAL DETAILS

**DIELECTRIC**  
**ELECTRODES**  
**ENCAPSULATION**

POLYETHYLENE TEREPHTHALATE.  
VACUUM DEPOSITED ALUMINIUM.  
POLYESTER TAPE WRAP & RESIN END SEAL.

**LEADS**

AXIAL TINNED COPPER, SEE TABLE OVERLEAF FOR DIAMETERS.

**ENVIRONMENTAL CLASSIFICATION**

40 / 085 / 21.

**WORKING VOLTAGE**

63 VDC.

**CAPACITANCE RANGE**

1  $\mu$ F - 22  $\mu$ F.

**TAN DELTA**

< 0.008 @ 1kHz, 20°C.

**INSULATION RESISTANCE**

>10,000 M $\Omega$ . $\mu$ F @ 20°C.

**TOLERANCES**

$\pm$  20%,  $\pm$  10%,  $\pm$  5%.

**MFD CAPACITORS (1991) LTD**, PENLEY, WREXHAM, LL13 OLY, U.K.

TEL: 01978 710551 FAX: 01978 710501 E Mail: sales@mfdcapacitors.co.uk

Website: www.mfdcapacitors.co.uk

## CAPACITOR DIMENSIONS

CAPACITANCE VALUE ( $\mu$ F )	DIMENSIONS ( mm )		
	L MAX	D MAX	d NOM
1.0	20	6.5	0.6
1.5	20	7	0.6
2.2	20	8	0.6
3.3	20	9	0.8
4.7	20	10	0.8
6.8	20	13	0.8
10.0	20	15	0.8
15.0	20	18	0.8
18.0	20	19.5	0.8
22.0	20	21	0.8

VALUES AND VOLTAGE RATINGS OTHER THAN THOSE SHOWN ARE AVAILABLE. CONTACT SALES OFFICE FOR DETAILS.

---

**MFD CAPACITORS (1991) LTD**, PENLEY, WREXHAM, LL13 OLY, U.K.  
TEL: 01978 710551 FAX: 01978 710501 E Mail: [sales@mfdcapacitors.co.uk](mailto:sales@mfdcapacitors.co.uk)  
Website: [www.mfdcapacitors.co.uk](http://www.mfdcapacitors.co.uk)