

# KP 20 METALLISED POLYPROPYLENE AND FOIL CAPACITORS AXIAL WRAP AND END FILL FORMAT

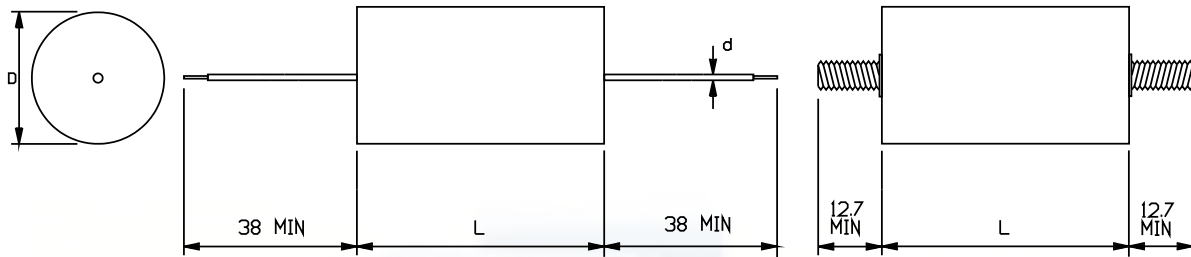

VERSION W (WIRE TERMINALS)

VERSION S (STUD TERMINALS)

SEE TABLE OVERLEAF FOR CAPACITANCE VALUES AND DIMENSIONS.

## GENERAL DETAILS

PULSE AND HEAVY DUTY AC CAPACITORS, CAPABLE OF OPERATION AT HIGH FREQUENCY AND HIGH DC VOLTAGE. TYPICAL USES INCLUDE SNUBBING NETWORKS, INVERTERS AND PULSE DISCHARGE CIRCUITRY.

## TECHNICAL DETAILS

### DIELECTRIC ELECTRODES

POLYPROPYLENE.  
VACUUM DEPOSITED ALUMINIUM AND ALUMINIUM FOIL.

### ENCAPSULATION TERMINALS

PETP TAPE WRAP & RESIN END SEAL.  
TINNED COPPER LEADS (FOR  $C \leq 100\text{nF}$ , INSULATED WIRE (32 / 0.2mm) OR STUDS.

### ENVIRONMENTAL CLASSIFICATION WORKING VOLTAGES

40 / 085 / 21.  
1500 VDC / 500 VAC.  
(PK AC + DC VOLTS MUST BE  $< 1500\text{ V}$ ).

### CURRENT CAPABILITY

30 X C ( $\mu\text{F}$ ) UP TO 10 A RMS MAX ON VERSION W, 20 A RMS MAX ON VERSION S.

### MAXIMUM $\delta v / \delta t$

500 V /  $\mu\text{S}$ .

### CAPACITANCE RANGE

10 nF - 2.2  $\mu\text{F}$ .

### TAN DELTA

$< 0.001$  @ 1kHz, 20°C.

### INSULATION RESISTANCE

$> 50,000\text{ M}\Omega$  @ 20°C,  $C \leq 1\text{ }\mu\text{F}$ .  
 $> 50,000\text{ M}\Omega \cdot \mu\text{F}$  @ 20°C,  $C > 1\text{ }\mu\text{F}$ .

### TOLERANCES

$\pm 20\%$ ,  $\pm 10\%$ ,  $\pm 5\%$ .

### TEMPERATURE

THE SURFACE TEMPERATURE RISE MUST BE  $\leq 5^\circ\text{C}$ . WHERE  $T_{\text{AMB}} > 70^\circ\text{C}$  THE SURFACE TEMPERATURE RISE MUST BE  $< 1^\circ\text{C}$ .

### TEST VOLTAGE (TERMINALS TO CASE)

3000 VAC 50 Hz FOR 60 S.

**MFD CAPACITORS (1991) LTD**, PENLEY, WREXHAM, LL13 OLY, U.K.

TEL: 01978 710551 FAX: 01978 710501 E Mail: sales@mfdcapacitors.co.uk

Website: www.mfdcapacitors.co.uk

CAPACITOR SIZES

VALUE	DIMENSIONS (MM)			
	L MAX	D MAX	VERSION W	VERSION S
			d NOM	THREAD
10 nF	34.5	7.7	0.8	N/A
15 nF	34.5	8.8	0.8	N/A
22 nF	34.5	10.5	0.8	N/A
33 nF	34.5	12.7	0.8	N/A
47 nF	34.5	14.9	0.8	N/A
68 nF	34.5	17.6	0.8	N/A
100 nF	34.5	21.5	0.8	N/A
150 nF	52.3	24.2	32 / 0.2	M6
220 nF	52.3	28.1	32 / 0.2	M6
330 nF	52.3	31.9	32 / 0.2	M6
470 nF	52.3	36.3	32 / 0.2	M6
680 nF	52.3	44	32 / 0.2	M6
1 $\mu$ F	52.3	50.6	32 / 0.2	M6
1.5 $\mu$ F	52.3	60.5	32 / 0.2	M6
2.2 $\mu$ F	52.3	74.8	32 / 0.2	M8

VALUES AND VOLTAGE RATINGS OTHER THAN THOSE SHOWN ARE AVAILABLE. CONTACT SALES OFFICE FOR DETAILS.